

# Cell Extraction and Lysis

## Extraction kits - Protein



Continuation

### B-PER bacterial protein extraction reagents, Thermo Scientific Pierce

**Thermo**  
SCIENTIFIC

NEW

PN

Catalogue No	Description
<b>PN78243</b>	<b>B-PER bacterial protein extraction reagent, 165mL</b>
<b>PN90084</b>	<b>B-PER bacterial protein extraction reagent, 250mL</b>
<b>PN78248</b>	<b>B-PER bacterial protein extraction reagent, 500mL</b>
<b>PN78266</b>	<b>B-PER bacterial protein extraction reagent (in phosphate buffer), 500mL</b>
<b>PN78260</b>	<b>B-PER II bacterial protein extraction reagent 2x formulation, 250mL</b>
<b>PN90078</b>	<b>B-PER bacterial protein extraction reagent with enzymes</b> Includes: B-PER reagent, 250mL Lysozyme 20mg/mL, 1 x 1.25mL DNase I 10,000U/mL, 1x 1.25mL
<b>PN90079</b>	<b>B-PER bacterial protein extraction reagent with enzymes</b> Includes: B-PER reagent, 500mL Lysozyme 20mg/mL, 2 x 1.25mL DNase I, 10,000U/mL, 2 x 1.25mL
<b>PN90080</b>	<b>B-PER direct bacterial protein extraction reagent</b> Sufficient reagents for 5 x 96 well plates. Includes: B-PER direct reagent, 50mL Lysozyme 20mg/mL, 1.25mL DNase I, 10,000U/mL, 1.25mL
<b>PN90081</b>	<b>B-PER direct bacterial protein extraction reagent</b> Sufficient reagents for 5 x 96 well plates. Includes: B-PER direct reagent, 250mL Lysozyme 20mg/mL, 5mL DNase I, 10,000U/mL, 5mL
<b>PN90082</b>	<b>Lysozyme, 0.5mL</b>
<b>PN90083</b>	<b>DNase I, 0.5mL</b>



### P-PER plant protein extraction kit, Thermo Scientific Pierce

**Thermo**  
SCIENTIFIC

NEW

PN

Extract protein without liquid nitrogen from all kinds of plant tissue.

- Versatile - works with multiple plant organs (leaf, stem, root, seed and flowers); multiple plant species (Arabidopsis, tobacco, maize, soybeans, peas, rice, spinach and other plant tissues); and fresh, frozen and dehydrated plant tissues
- Convenient - requires no liquid nitrogen/freeze-grinding, Dounce homogenisation, blade-shearing or glass-bead agitation for cell disruption; however, the P-PER kit is compatible with these alternative mechanical aids
- Compatible - downstream applications include 1D and 2D gel electrophoresis, Western blotting, activity assays, and protein affinity purifications
- Quantifiable - P-PER kit extracts can be quantified using the BCA protein assay kit, reducing agent compatible
- Ready to use - protein extract does not require filtration through cheesecloth or miracloth, unlike homebrews
- Fast - perform plant cell lysis and protein extraction in 10 minutes
- Recovers active protein - assays show extracted proteins are functional

The Thermo Scientific Pierce P-PER plant protein extraction kit offers a new method for performing plant cell lysis and subsequent protein extraction. The P-PER kit includes an organic lysing reagent and two aqueous reagents which, in conjunction with mild mechanical agitation, effectively extract plant protein. This gentle extraction procedure avoids harsh mechanical lysis aids, such as a mortar and pestle.

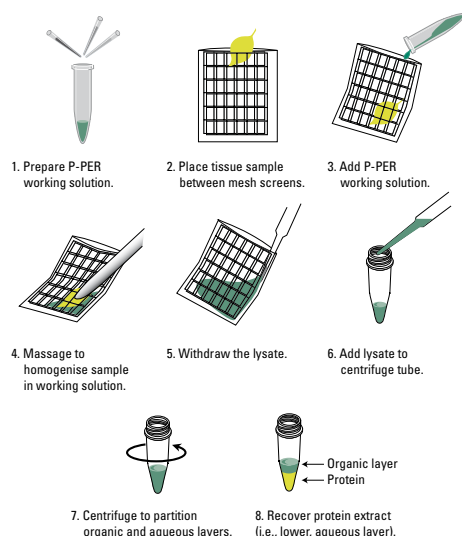

Catalogue No	Description
<b>PN89803</b>	<b>P-PER plant protein extraction kit</b> Includes: P-PER reagent A, 20mL P-PER reagent B, 225μL P-PER reagent C, 20mL Polypropylene mesh bags, x 20